

REZONING EXHIBIT "A"

BEING A PART OF THE SOUTHWEST 1/4 AND SOUTHEAST 1/4 OF SECTION 34, TOWN 8 NORTH,
RANGE 18 EAST, IN THE VILLAGE OF HARTLAND, WAUKESHA COUNTY, WISCONSIN.

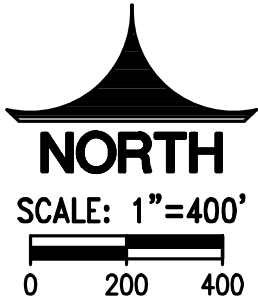
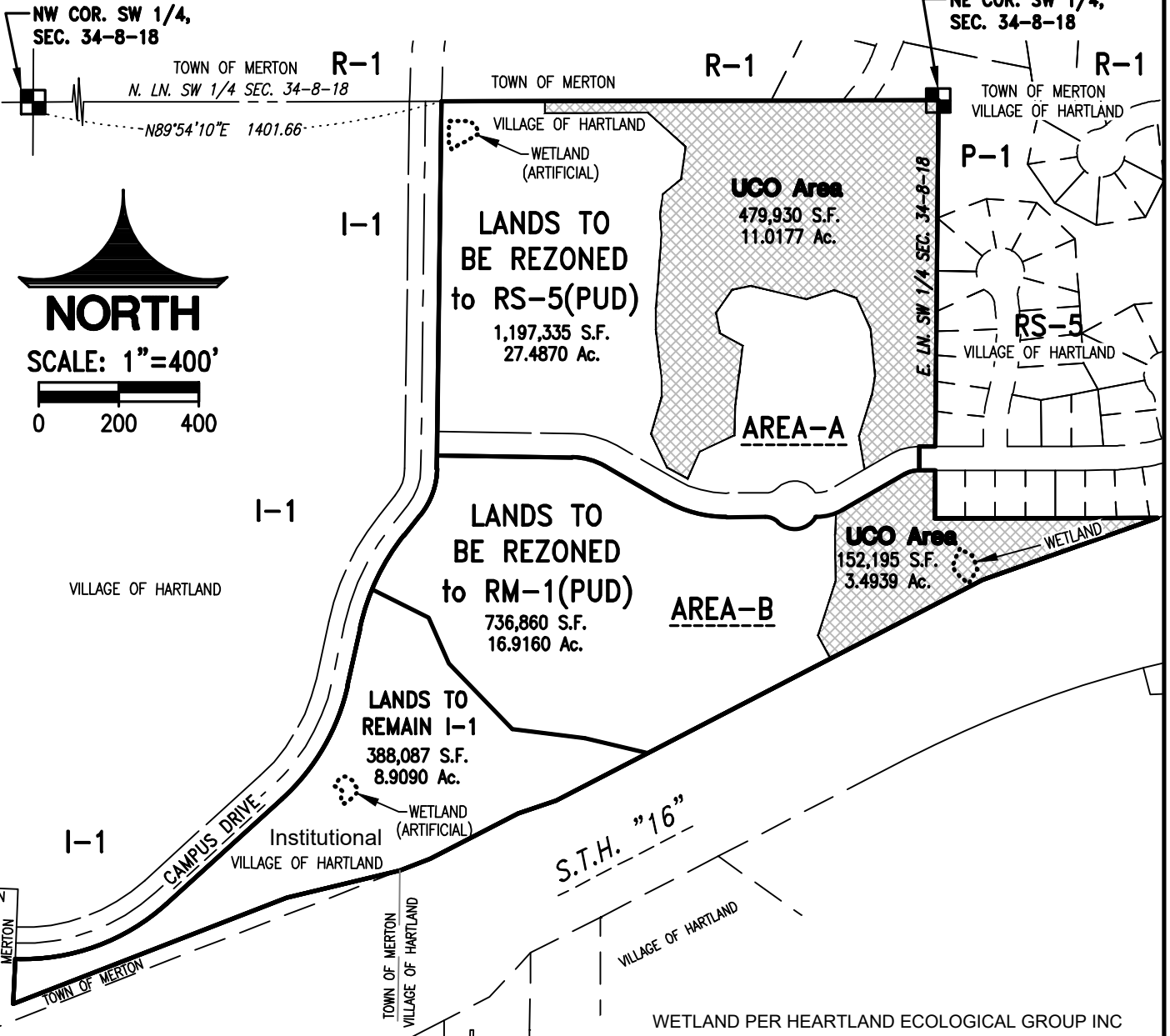

WETLAND PER HEARTLAND ECOLOGICAL GROUP INC

LAND AREA SUMMARY	
AREA-A	RS-5 (PUD)
TOTAL AREA=	1,197,335 S.F. (27.4870 Ac.)
UCO AREA=	479,930 S.F. (11.0177 Ac.)
NET AREA=	717,405 S.F. (16.4694 Ac.)
AREA-B	RM-1 (PUD)
TOTAL AREA=	736,860 S.F. (16.9160 Ac.)
UCO AREA=	152,195 S.F. (3.4939 Ac.)
NET AREA=	584,665 S.F. (13.4221 Ac.)



4100 N. CALHOUN ROAD
Suite 300
Brookfield, WI 53005
Phone: (262) 790-1490
Fax: (262) 790-1461

H:\C900\953\19023-01\Survey\ESMT-EXHIBITS\REZONING EXH-090320.dwg

REZONING EXHIBIT “A”

LEGAL DESCRIPTION of lands to be REZONED to RS-5 (PUD):

Being a part of Lot 2 of Certified Survey Map No. 10497, located in a part of the Northeast 1/4 of the Southwest 1/4 of Section 34 Town 8 North, Range 18 East, in the Village of Hartland, Waukesha County, Wisconsin, now being more particularly bounded and described as follows:

Beginning at the Northeast Corner of the said Southwest 1/4 of said Section 34; Thence South 00°30'48" West and along the East line of the said Southwest 1/4 Section, 865.02 feet to a point; Thence South 89°53'13" West, 40.00 feet to a point; Thence South 00°30'48" West, 60.00 feet to a point; Thence South 89°53'13" West, 2.23 feet to a point of curvature; Thence Southwesterly 36.65 feet along the arc of a curve, whose center lies to the Southeast, whose radius is 70.00 feet, whose central angle is 30°00'04", and whose chord bears South 74°53'11" West, 36.24 feet to a point of tangency; Thence South 59°53'09" West, 177.43 feet to a point of curvature; Thence Southwesterly 68.07 feet along the arc of a curve, whose center lies to the Northwest, whose radius is 130.00 feet, whose central angle is 30°00'00", and whose chord bears South 74°53'09" West, 67.29 feet to a point of tangency; Thence South 89°53'09" West, 3.54 feet to a point of curvature; Thence Southwesterly 109.34 feet along the arc of a curve, whose center lies to the North, whose radius is 60.00 feet, whose central angle is 104°24'55", and whose chord bears South 82°05'37" West, 94.83 feet to a point of reverse curve; Thence Northwesterly 34.88 feet along the arc of a curve, whose center lies to the Southwest, whose radius is 45.00 feet, whose central angle is 44°24'55", and whose chord bears North 67°54'23" West, 34.02 feet to a point of tangency; Thence South 89°53'09" West, 97.36 feet to a point of curvature; Thence Northwesterly 159.70 feet along the arc of a curve, whose center lies to the Northeast, whose radius is 305.00 feet, whose central angle is 30°00'00", and whose chord bears North 75°06'51" West, 157.88 feet to a point of tangency; Thence North 60°06'51" West, 172.81 feet to a point of curvature; Thence Northwesterly 86.50 feet along the arc of a curve, whose center lies to the Southwest, whose radius is 170.00 feet, whose central angle is 29°09'11", and whose chord bears North 74°41'26" West, 85.57 feet to a point of tangency; Thence North 89°16'02" West, 337.64 feet to a point on the said East Right-of-Way line of "Campus Drive"; Thence North 00°43'57" East and along said East Right-of-Way line, 885.92 feet to a point on the North line of said Southwest 1/4 Section; Thence North 89°54'10" East along said North line, 1241.53 feet to the point of beginning of this description.

Said Parcel contains 1,197,335 Square Feet (or 27.4870 Acres) of land, more or less.

LEGAL DESCRIPTION of lands to be REZONED to RM-1 (PUD):

Being a redivision of Lot 2 of Certified Survey Map No. 12049, located in a part of the Northeast 1/4, Southeast 1/4, Northwest 1/4 and Southwest 1/4 of the Southwest 1/4 and part of the Northwest 1/4 of the Southeast 1/4 of Section 34, Town 8 North, Range 18 East, in the Village of Hartland, Waukesha County, Wisconsin, bounded and described as follows:

Commencing at the Northeast Corner of the said Southwest 1/4 of said Section 34; Thence South 00°30'48" West and along the East line of the said Southwest 1/4 Section, 925.02 feet to the place of beginning of this description;

Thence South 89°53'13" West, 42.23 feet to a point; Thence Southwesterly 36.65 feet along the arc of a curve, whose center lies to the Southeast, whose radius is 70.00 feet, whose central angle is 30°00'04", and whose chord bears South 74°53'11" West, 36.24 feet to a point; Thence South 59°53'09" West, 177.43 feet to a point; Thence Southwesterly 68.07 feet along the arc of a curve, whose center lies to the Northwest, whose radius is 130.00 feet, whose central angle is 30°00'00", and whose chord bears South 74°53'09" West, 67.29 feet to a point; Thence South 89°53'09" West, 3.54 feet to a point; Thence Southwesterly 109.34 feet along the arc of a curve, whose center lies to the North, whose radius is 60.00 feet, whose central angle is 104°24'55", and whose chord bears South 82°05'36.5" West, 94.83 feet to a point; Thence Northwesterly 34.88 feet along the arc of a curve, whose center lies to the Southwest, whose radius is 45.00 feet, whose central angle is 44°24'55", and whose chord bears North 67°54'23" West, 34.02 feet to a point; Thence South 89°53'09" West, 97.36 feet to a point; Thence Northwesterly 159.70 feet along the arc of a curve, whose center lies to the Northeast, whose radius is 305.00 feet, whose central angle is 30°00'00", and whose chord bears North 75°06'51" West, 157.88 feet to a point; Thence North 60°06'51" West, 172.81 feet to a point; Thence Northwesterly 86.50 feet along the arc of a curve, whose center lies to the Southwest, whose radius is 170.00 feet, whose central angle is 29°09'11", and whose chord bears North 74°41'26.5" West, 85.57 feet to a point; Thence North 89°16'02" West, 337.64 feet to a point on the East Right-of-Way line of "Campus Drive"; Thence South 00°43'57" West, along said East Right-of-Way line, 32.99 feet to a point; Thence Southwesterly 125.47 feet along said East Right-of-Way line and the arc of a curve, whose center lies to the Northwest, whose radius is 190.00 feet, whose central angle is 37°50'14", and whose chord bears South 19°39'04" West, 123.21 feet to a point; Thence South 38°34'11" West along said East Right-of-Way line, 65.30 feet to a point; Thence Southwesterly 155.89 feet along said East Right-of-Way line and the arc of a curve, whose center lies to the Southeast, whose radius is 560.00 feet, whose central angle is 15°57'00", and whose chord bears South 30°36'10" West, 155.39 feet to a point; Thence South 63°08'36" East, 158.46 feet to a point; Thence South 23°39'30" East, 124.50 feet to a point; Thence South 44°05'55" East, 227.47 feet to a point; Thence South 82°36'43" East, 183.02 feet to a point; Thence South 76°51'47" East, 161.67 feet to a point on the Northwesterly Right-of-Way line of S.T.H. "16"; Thence North 62°39'50" East and along the said Northwesterly Right-of-Way line, 942.58 feet to a point; Thence North 70°31'26" East and along the said Northwesterly Right-of-Way line, 462.77 feet to a point on the South line of "Chestnut Ridge"; Thence South 89°53'13" West along said South line, 557.01 feet to a point on the East line of "Chestnut Ridge"; Thence North 00°30'48" East and along the said East line, 120.01 feet to the point of beginning of this description.

Said Parcel contains 736,843 Gross Square Feet (or 16.9156 Acres) of land, more or less.

Date: 9/3/2020

Deborah L. Joers, P.L.S.
Professional Land Surveyor, S-2132
TRIO ENGINEERING, LLC
4100 N. Calhoun Road, Suite 300
Brookfield, WI 53005
Phone: (262)790-1480 Fax: (262)790-1481